

Antistatic Bars

Model 200-201 AC Antistatic Bars

Model 200-201 high performance bars utilize advanced electro-static technology to eliminate costly static electricity problems, including high-speed web applications.

The powerful performance of SET-ION ionizer bars provide very short ionizing time and effective ionization, even at high static loads.

The Ion-Edge effectively eliminates positive and negative static charges that interfere with production speeds and product quality, while decreasing rejects and downtime.

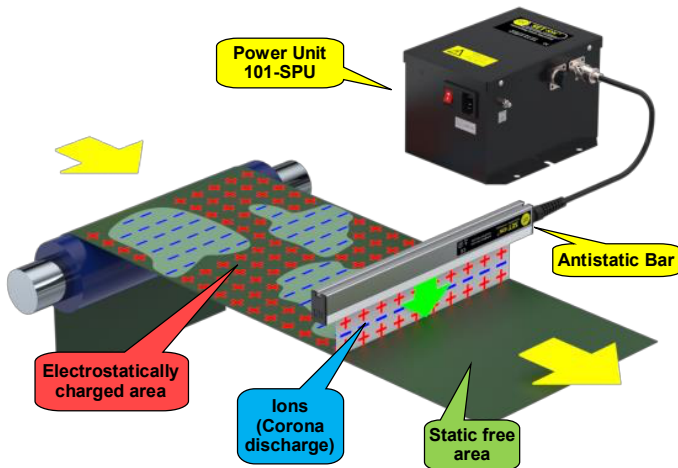

Specifications

Construction	Anodised aluminium, epoxy resin, PVC and hardened etched emitters.		
Length Model 200	Customer Specific: 80mm - 6000mm Total Length = Active Length + 50mm		
Length Model 201	Single Entry: 200mm - 6000mm Total Length = Active Length + 125mm		
	Double Entry: 300mm - 6000mm Total Length = Active Length + 200mm		
Cable	Hi-Flex high voltage screened cable with 60 mm bend radius. Standard length is 2 m - longer lengths can be specified at time of order (subject to maximum load on power unit). 90° cable exit option.		
Environment	Temperature: 60°C max	Humidity:	70% rH Max
Safety	5 mA maximum current from Power Unit. The system limits current to below 50 µA on the emitters.		
Working Distance	Up to 200mm. Best working distance 20 - 50mm		
Power Supply	100-SPU or 101-SPU SET-ION AC Power Supply 4 Outputs 7-8kV		

How It Works : The electrodes on the ionizer are energized by the Power Unit. The electrodes emit this energy (corona discharge) in the form of a field of ionised air. This ionized air supplies the positive and negative ions necessary to neutralize the static charge. Electrostatically charged products which pass through this corona are immediately neutralised and become static free.

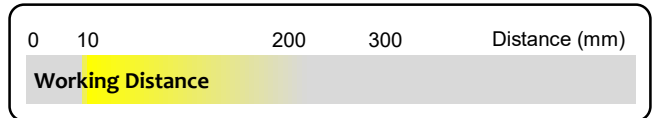

- Stay-sharp emitters. No deterioration in performance due to emitter erosion
- Emitters at 10 mm pitch for maximum ionisation
- Fully encapsulated electrical assembly, for market-leading reliability and safety
- Waterproof and suitable for applications in food and pharmaceuticals, where washdowns are required
- Compact and easy to install. The groove on the underside of the bar gives fast and simple installation
- Compact design allows for operation in areas where space is limited
- Rugged, durable construction for a long life in industrial applications
- Operating distances of up to 200mm
- Market-leading performance for high static charge and fast speed applications
- Completely shockless in operation, despite high power
- Different Connection Options;
 - Compact model (plug connector)
 - Normal terminal connection
 - 90° cable exit option
 - Bars supplied in series - joined by cable
- Plug-in Connector Type Only;
 - High performance screened HT cable
 - High flexibility. Suitable for routing around intricate machinery
 - Best choice for robot arms and moving machinery



Antistatic Bars

Model 200-201 AC Antistatic Bars

Operating Description

Contact and separation between two surfaces creates static electricity, which can often cause materials like paper, plastic, textiles and other non-conductive materials to randomly attract to or repel from themselves or their surroundings.

In a manufacturing environment this causes process problems which include jams, clogs, mis-feeds, poor stacking, reduced transport speeds, shocks to operators, fires, explosions, and a variety of contamination related problems.

The 200 and 201 Models are **shockless** static neutralizing bars designed to help you control these troublesome and costly problems by neutralizing the static electricity that causes them.

Dimensions

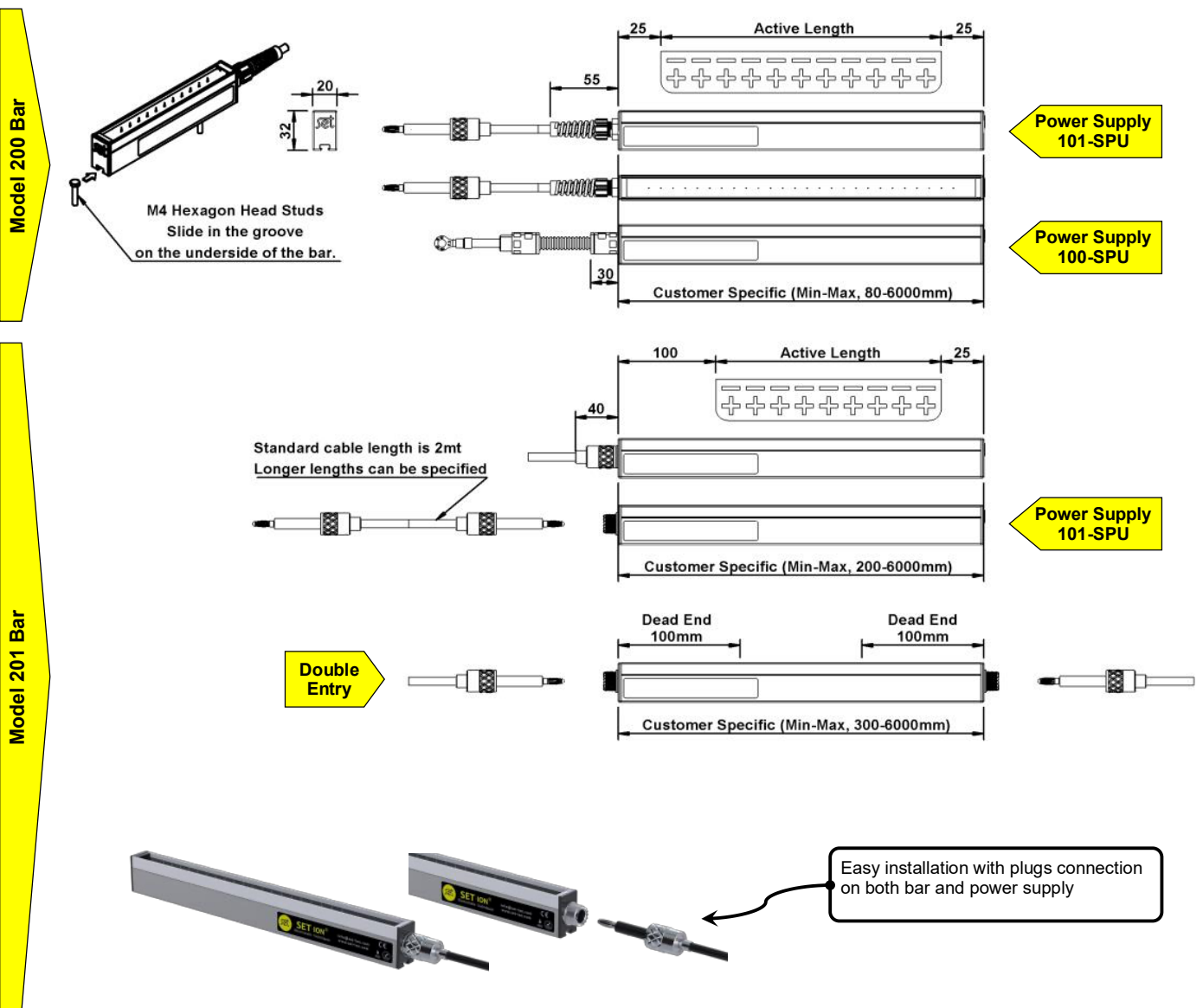

Antistatic Bars

Model 200-201 AC Antistatic Bars

Standard and Optional Specifications

Which Power Supplies to Use

Plug-in Connector Model



Model 201



Model 200-K



Model 101-SPU

Terminal Connection Model



Model 200



Model 100-SPU

Optional Serial Connections

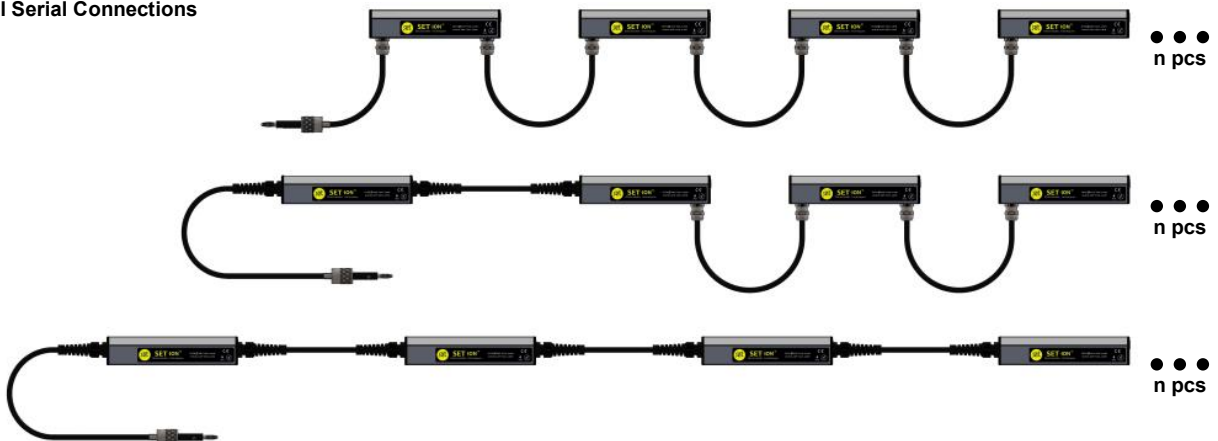

Applications

CONVERTING Evenly distributes effective ionization.
 • Sheeting • Slitting • Laminating • Coating • Bag making
 • Die cutting • Unwinding • Rewinding • Clean room • Paper and film
 • Electronic assembly

PLASTICS Eliminates dust/dirt contamination and flow problems.
 • Plastic extrusion • Web handling • Bag wicketing
 • Forming and molding

PRINTING Saves production time and rejects/waste.
 • Labeling • Sheet-fed • Wide format • Collating • Binding • Folding

PACKAGING Eliminates tough static problems.
 • Over wrapping • Form, fill and seal • Palletizing
 • Shrink wrapping • Labeling operation • Stocking

TEXTILES & NON-WOVENS Speeds production.
 • Accumulators • Creels • Weaving • Bonding • Wolding
 • Carding • Slashing • Warping • Winding

